



BUILDING
OUR FUTURE
HOLY ROSARY CAPITAL CAMPAIGN



A NOTE FROM
**Fr. Gallagher
 and
 Mr. Mullis**



“Go therefore
 and make
 disciples
 of all nations...”
 ~ Matthew 28:19

Dear Friends,

Since its humble beginning in 1954, Holy Rosary Church and School have been a beacon of light and hope. Our community has spread the gospel in East Memphis and beyond by celebrating the sacraments, educating our children in the way of the Faith, serving the needs of the sick and the poor, and continuing the mission of the Church to build up the Body of Christ. Today we recognize the growth of the Catholic presence in our midst and the unique richness of our heritage. God’s providence has been evident over these many years. As good stewards, we strive to carry on the wonderful tradition of generosity and faith of those who have gone before us.

During the past several years, the Building & Grounds Committee in collaboration with Hord Architects, have carefully reviewed the needs of our flourishing faith community. All aspects of parish life and campus facilities were considered, to determine the best course of action. In the fall of 2022, our parish and school families were invited to participate in a planning study. Through much discussion and consultation, plans to move forward with the construction of a new southern wing of the school building were reformulated and refined.

Now is the time to take the next step toward accomplishing these plans. As we embark on the **Building Our Future** Capital Campaign, we seek to raise the necessary funds to begin our project.

The capital campaign presents a serious and important challenge. We realize that we will need the support of all our parish family members. By working together, we can help ensure that the Holy Rosary legacy of service to Our Lord, one another, our children, and the wider community will endure for generations to come.

We are confident that through our prayers, sacrifice, and faithfulness, God, who has begun this good work in us, will guide our efforts to a successful completion.

Yours in Christ,

Rev. Patrick Gallagher
 Pastor

Sincerely,

Mr. Darren Mullis
 Principal

Our Challenge

For nearly 70 years, we have been blessed to provide an exceptional education in our original facilities. However, the oldest structures of our school, in particular the 1950’s wing, needs our attention. Continued repairs and maintenance are extensive and very expensive due to deterioration and the age of the building. Renovating and expanding the existing facility has been considered, but is not cost effective. Therefore, it was decided to tear down and construct a new school wing that best facilitates inspired and engaged learning.



Our History

As the new millennium dawned, Holy Rosary parish leadership thoroughly inspected the state of the church and school buildings. Recognizing the limitations and inadequacy of the campus facilities to meet the demands of our faith community, parish leadership developed a master plan to resolve the identified issues. In Phase I of the master plan, a new parish center was completed in 2010 with great success.

The next step Phase II, replacing the oldest section of the school, was on hold for a few years due to the pandemic. Consequently, it was necessary to review the architect's original design to ensure up-to-date pricing and fiscally responsible planning. Diligent research by Hord Architects into these concerns led to a simplified redesign of the new building.



Our Plan

A two story building will replace the 1950's one story wing. The new building will consist of school offices, two learning centers, six classrooms, an infirmary, lavatories, print/storage area, and mechanical rooms. It will also feature a more identifiable and secure entryway to the school. Ease of access into the building and an improved ergonomic interior design will greatly benefit everyone, especially persons with physical difficulties.

The new wing will accommodate the growing programs within Holy Rosary School that meet the demands of students in our community. It will provide much needed space for The Learning Center (TLC) program. TLC serves students with language-based learning differences such as dyslexia. The program is a 4:1 learning environment with two classes per classroom. Since its inception in 2018, enrollment has increased from six students to 35.

Another specialized program we offer is The ANGEL Program, serving students living with autism. Students in this program will have the opportunity to engage with the most update-to-date technology and flourish in the space afforded by a new facility.

Our enrollment capacity will remain the same; however, we will gain more spacious and efficient classrooms. Additionally, new facilities will aid the effort to maintain our enrollment by appealing to both current and prospective school families. Most importantly, it will provide an environment better suited to learning for our students.

Strategic Advantages

There are many additional benefits to building new. First and foremost, it is a better long-term investment. Renovating the existing facilities would cost up to 75% or more of the cost of a new building. Second, the existing 1950s school wing is well beyond its anticipated life expectancy. Moreover, the proposed new building will have far greater longevity. Third, the new building will be more energy efficient, reducing operation costs. Fourth, starting with a fresh template affords us the opportunity to specifically design the new facility to meet our needs without the constraints of an existing floor plan. Fifth, it will enable us to more readily adapt to the periodic but necessary technological upgrades. Finally, building new allows for more greenspace and better use of the limited land we own.

Catholic Education and Formation have always been integral and essential ministries of Holy Rosary. This project is key to ensuring a Faith-based education for all students that fosters excellence in the spiritual, academic, physical, and social formation of students. It will positively impact the life of Holy Rosary Church and School as well as the East Memphis community for generations.

Summary

To achieve our objectives, Holy Rosary parish leadership has launched the Building Our Future Capital Campaign. The overall estimated financial need to accomplish all of these projects is \$7.5 million, which includes the parish portion to the Diocese of Memphis Campaign United In Faith. Our goal is to raise \$2.5 million or more from within the parish and school. Funds will also be sought from other sources outside of the parish. (See page 7).



United in Faith

CELEBRATING 50 YEARS OF OUR
CATHOLIC FAITH HERE IN WEST TENNESSEE

Support the Diocese of Memphis

The diocesan **United in Faith** Capital Campaign is raising funds for the establishment of endowments for seminarian education, priest retirement, permanent diaconate education, youth, college, and young adult ministry. The funds in these endowments will be professionally managed by The Catholic Foundation of West Tennessee to ensure transparency and growth in our diocese.

To learn about the
United In Faith campaign,
please visit unitedinfaithcampaign.org

Our Vision



Project Overview

The following numbers illustrate our need:

Hard Cost New Two Story 12,000 Sq. ft. Building	\$5,639,802
<small>(Combines Classrooms, Learning Centers, and Offices)</small>	
<small>Demolition of Existing Building (1950s wing of school), Hazardous Material Removal Asbestos Abatement), Filing Fee for Permits</small>	
Soft Cost	\$845,970
<small>Architecture, Electrical, HVAC, and Plumbing Engineering, Fire Protection Engineering, Structural Engineering, Interior Design, Civil Engineering and Landscape design, Geotechnical Engineering, Builders Risk Insurance, Testing Services during Construction, Reimbursable Expenses (printing, etc.)</small>	
Furniture/ Fixtures/Equipment	\$100,000
<small>(Assumes Reuse of Some Materials)</small>	
<small>Furniture, Telecom Equipment, Security System, A/V, Interior and Exterior Signage</small>	
Project Contingency/Safety Net (5% of Subtotal)	\$329,289
Estimated Subtotal:	\$6,915,061
<small>Diocese of Memphis United In Faith Campaign</small>	<small>\$468,000</small>
<small>Fundraising Consultants and Materials</small>	<small>\$125,000</small>
GRAND TOTAL:	\$7,508,061

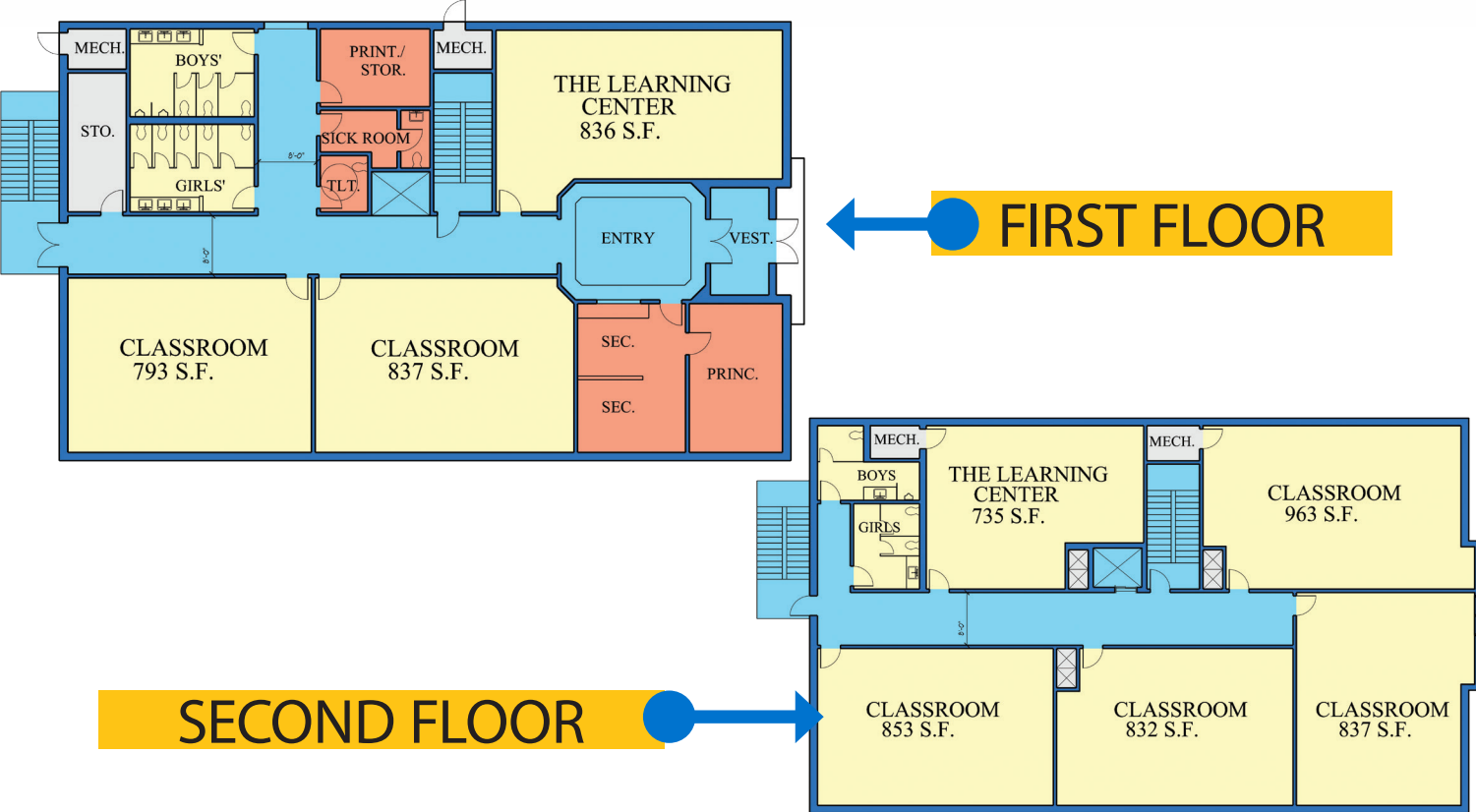

How You Can Get Involved

Throughout the **Building Our Future** Capital Campaign, Father Gallagher and the Campaign Leadership and volunteer workers will reach out to all members of our church and school family to communicate our goals and articulate how everyone can get involved. These efforts are aimed at giving all members of Holy Rosary parish, school parents, and alumni, an opportunity to participate.

Every family is asked to consider all the information contained in this brochure and then make a prayerful decision about how to support the campaign. Those who do not respond will be personally contacted by volunteers who will undertake the vital task of reaching out to increase campaign awareness. During the campaign, we are asking everyone who shares in the mission of Holy Rosary to do the following:

1. **Pray for the success of the campaign.**
2. **Be an ambassador for Holy Rosary by sharing key information and enthusiastically encouraging others to get involved.**
3. **Make a sacrificial pledge.**

Whether you participate by attending a campaign reception, responding at Mass or via mail, or by graciously receiving a visit from a fellow parishioner, it is your active involvement that will make this campaign a success.



“What shall I return to the Lord for all he has given me?”

~Psalm 116:12

How To Pledge Your Support

Holy Rosary Church & School seeks to raise \$2.5 million or more through this campaign. Additional funds will be sought from other sources outside of the parish. Every member of our parish and school community is integral to our success in reaching this goal and, therefore, each family is asked to consider making a pledge to the campaign to the best of their ability.

Each family is asked to consider a pledge of \$5,000 or more, payable over three years. A pledge of \$5,000, after a down payment of \$500, is \$125 per month for three years (or \$138.89 per month without a down payment). This breaks down to only \$30 per week!

We Need Your Special Generosity

Everyone is asked to prayerfully consider how their generosity can reflect their gratitude for the gifts that God has given them. We know that a pledge of \$5,000 will be a challenge for some of our parish households. Therefore, it is vital to the success of our campaign that those who are able to make larger pledges do so.

Individuals who are financially capable of pledging \$10,000, \$25,000, \$50,000 or more, are asked to step forward and become leaders in our campaign. Please review the Suggested Gift Plans on the following page and choose a plan that is right for you and your family.

In Deuteronomy 16:10 we are reminded that “the measure of your own free will offering should be in proportion to the blessing the Lord has bestowed on you.”

Keep In Mind The 3 Facets Of Parish Giving

Offertory:

Your weekly contributions to the general collection support the day-to-day operating expenses of the parish, including Faith Formation, Catholic education, liturgy, maintaining our facilities and personnel.

Annual Catholic Appeal (ACA):

Each year parishioners are asked to support the Diocese of Memphis through the Annual Catholic Appeal (ACA) supplementing Seminarian Education, Family Ministry, Religious Education, Catholic Charities, and various other ministries and services.

Building Our Future Capital Campaign:

It is important to keep in mind that your payments to the campaign be in addition to your regular offertory contributions and annual appeal contributions. Your campaign pledge is a restricted gift – to be used solely for the project cited in this brochure.



Suggested Gift Plans

Total Gift	10% Down Payment	3 Annual Payments	12 Quarterly Payments	36 Monthly Payments	Weekly Sacrifice
\$250,000	\$25,000	\$75,000	\$18,750	\$6,250	\$1,500
\$100,000	\$10,000	\$30,000	\$7,500	\$2,500	\$600
\$50,000	\$5,000	\$15,000	\$3,750	\$1,250	\$300
\$40,000	\$4,000	\$12,000	\$3,000	\$1,000	\$240
\$25,000	\$2,500	\$7,500	\$1,875	\$625	\$150
\$20,000	\$2,000	\$6,000	\$1,500	\$500	\$120
\$15,000	\$1,500	\$4,500	\$1,125	\$375	\$90
\$10,000	\$1,000	\$3,000	\$750	\$250	\$60
\$7,500	\$750	\$2,250	\$562.50	\$187.50	\$45
\$5,000	\$500	\$1,500	\$375	\$125	\$30

The gift plans in this brochure are provided as a suggested guideline when considering your pledge. Please review the gift plans carefully and select one that fits your family's financial situation. Pledges are not legally binding, but rather the expression of your intent.

Pledging Information

- Please make checks payable to **HRC Building Our Future**
- Payments will be set up over a three-year period. If desired, a longer or shorter period may be arranged.
- Gift plans are based on a 10% down payment. However, a down payment is not necessary to begin your pledge.
- To make your pledge via credit, debit or automatic draft, please visit: www.holyrosarychurchmphs.org/donate or scan the QR code above.



Not everyone can make the same size gift, but everyone can make an equal sacrifice.

If you have any questions about the campaign or making your pledge, please contact the Campaign/ Development Office at 901.767.6949.

Methods Of Pledging

Pledges via Cash or Check

Simply complete your pledge card by noting the amount of your pledge and down payment. Be sure to select your method of payment, i.e., monthly, quarterly, semi-annual or annual payments. Please make checks payable to **HRC Building Our Future**.

You will be sent payment reminders and a special payment envelope in accordance with the payment plan you choose. You may return the pledge card in the weekly collection, bring it to the parish office, or return it by mail.

Pledges Via Debit Or Credit Card

Please visit www.holyrosarychurchmphs.org/donate/ to make your pledge via debit or credit card. In addition, please return your completed pledge card to the Development Office.

Gifts of Stock

You may use your own broker/agent or the parish's agent to transfer gifts of stock. If the stock has been held for one year or longer, you do not have to pay capital gains tax on the stock, and are allowed a tax deduction for the full value of the stock, provided that the stock is transferred to the parish before being liquidated. The stock is not required to have appreciated in value since you purchased it. If you are interested in a stock donation, please contact the Campaign Office or make a notation on the pledge card so we may provide you with the necessary information.

Gifts of Property, Life Insurance, Annuities, Wills or Bequests

There are different ways to support Holy Rosary Parish both today, and in the years to come via planned giving. Families or individuals can make gifts of real estate, personal property, automobiles, life insurance, estate bequests, annuities or charitable remainder trusts. For substantial gifts of property other than marketable securities, the IRS requires an appraisal. Please contact the Parish Office for more information*.

**Please confirm current tax law with your tax advisor or the IRS.*



IRA Contributions

An IRA owner, age 70½ or over, can directly transfer tax-free up to \$100,000 per year to an eligible charity. This option can be used for distributions from IRAs, regardless of whether the owners itemize their deductions. Distributions from employer-sponsored retirement plans, including SIMPLE IRAs and simplified employee pension (SEP) plans, are not eligible*.

To qualify, the funds must be transferred directly by the IRA trustee to the eligible charity. Distributed amounts may be excluded from the IRA owner's income — resulting in lower taxable income for the IRA owner*.





THANK YOU!

CAMPAIGN PRAYER

HEAVENLY FATHER,

We thank you for all the blessings you have bestowed on our Holy Rosary family. May our lives reflect your faithfulness and witness to your unfailing love. Guide us in our work together, that all we do may be for your glory.

Send your Holy Spirit upon us and open our hearts to generously respond to your call. Keep us ever mindful of the mission and purpose of our church and school. We ask this through the intercession of Our Lady, Queen of the Holy Rosary, in the name of Jesus Christ Our Lord.

AMEN.



We would not have come this far in this effort without the assistance of a special group of dedicated people serving on the **Building Our Future** Campaign Committee. They continue to provide us with the tools and direction we need to be successful.

**Special thanks to the Parish & School
Staffs and our loyal Campaign
Volunteers...**